



A N *d* A Z™ | PRAGUE



# OUR STORY

Our story begins with an expression of prosperity. In 1916, the Association of Sugar Manufacturers built a monumental **Sugar Palace** in the center of Prague on the Haymarket square to emphasize their influence on one of the world's most robust economies. The magical spot also houses one of Prague's oldest towers. Prague is called a city of 100 spires and Henry's Bell Tower is one of them. Adjacent directly to the Sugar Palace, together they create a majestic landmark.





# ACCESSIBILITY

## BY AIR

- 25 minutes car drive from the International Airport to the city center
- Direct flight connections to 115 destinations

## BY CAR

- Indoor & outdoor secure parking facilities
- Valet parking service available

## BY RAIL

- Main railway station Hlavní Nádraží only 5 minutes walking distance from the hotel
- Excellent railway connections with Austria, Hungary, Germany, Poland and Slovakia

## BY BUS

- Bus access without permit
- Bus overnight parking within walking distance





AIRPORT  
RAILWAY STATION

25 MINUTES CAR  
5 MINUTES WALKING

CHARLES  
BRIDGE

NATIONAL LIBRARY  
OF THE  
CZECH REPUBLIC

PRAGUE  
ASTRONOMICAL  
CLOCK

THE OLD TOWN  
SQUARE

PALLADIUM  
SHOPPING  
CENTER

SMETANA CONCERT HALL

MUNICIPAL HOUSE

THE POWDER TOWER

STATION  
HLAVNÍ NÁDRAŽÍ

WENCESLAS  
SQUARE

FRANZ KAFKA  
ROTATING HEAD

Národní Street

Na Příkopě Street

Wilsonova Street



# HISTORICAL & CONTEMPORARY *LUXURY*

Many features within the interior of our hotel and bright, airy rooms draw you back to the legends and myths that helped shape Prague and the nation. Let Bruncvik's white lion bravely accompany you on your way through the hotel and enjoy the story each thoughtful detail has to tell.







# 152 STANDARD, DELUXE & PREMIUM ROOMS

Flooded with natural light, all our rooms feature luxurious custom-made furniture and interiors, designed in the purest art nouveau tradition.

Reflecting Prague's myths and legends, our rooms offer views to Henry's Bell Tower, Church of St. Henry, Haymarket & Grainmarket or the beautiful Dancing Musicians Fountain.







# 24 SUITES

*6 JUNIOR SUITES, 6 ANDAZ SUITES,  
11 WINTERGARDEN SUITES, 1 SUGAR PALACE SUITE*

Indulge in our collection of suites, ranging from 44 sq-meters Junior Suites to our spacious Signature Suites sized from 60 to 130 sq-meters, combining classical Bohemian characteristics, stucco decorated high ceilings, state-of-the-art facilities and luxury amenities.









# 5 MEETING & EVENT ROOMS

Andaz Prague offers flexible 450 sqm of event spaces which are immersed in the rich culture of Prague. Host impressive events in the hotel's historic settings of the Sugar Palace which provide a unique backdrop for business meetings and social celebrations.















# VENUES

## ANDAZ STUDIOS

3 flexible event spaces that can accommodate any type of event from a small boardroom meeting or private dinner through to a conference for up to 124 guests, a cocktail reception for 115 or a product launch. The Andaz Studios are combinable up to a total 150 sq-meters.

## COLLEGIUM I & II

Once used by Prague's Sugar Barons as Collegium, these rooms are truly unique and stunning venues in every sense. Flooded with light through grand windows on both sides, magnificent high ornate ceilings and oak parquet flooring these rooms are sure to spark creativity and inspiration.





# GROUND FLOOR

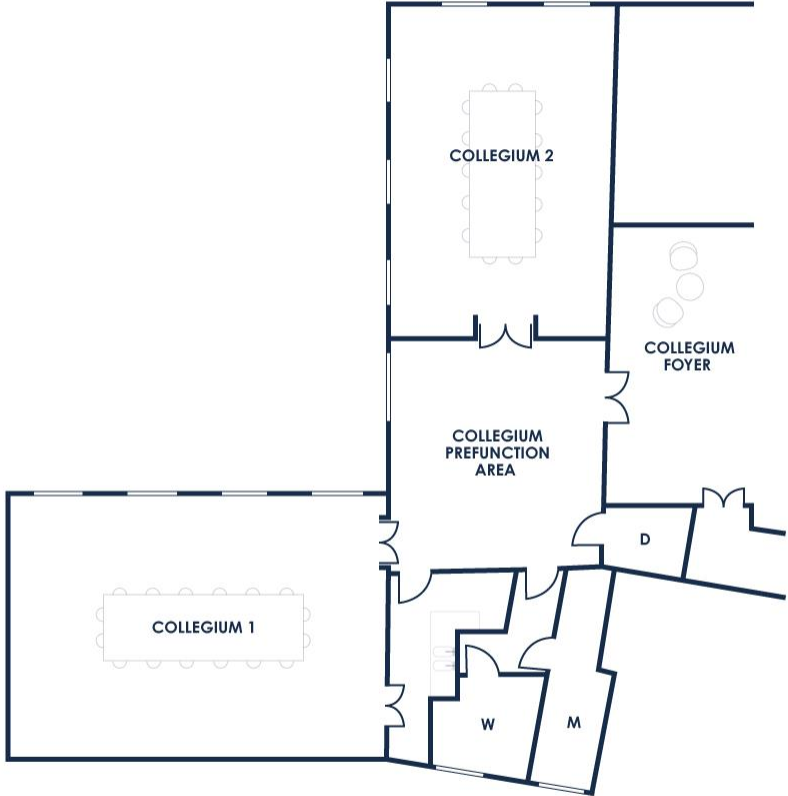
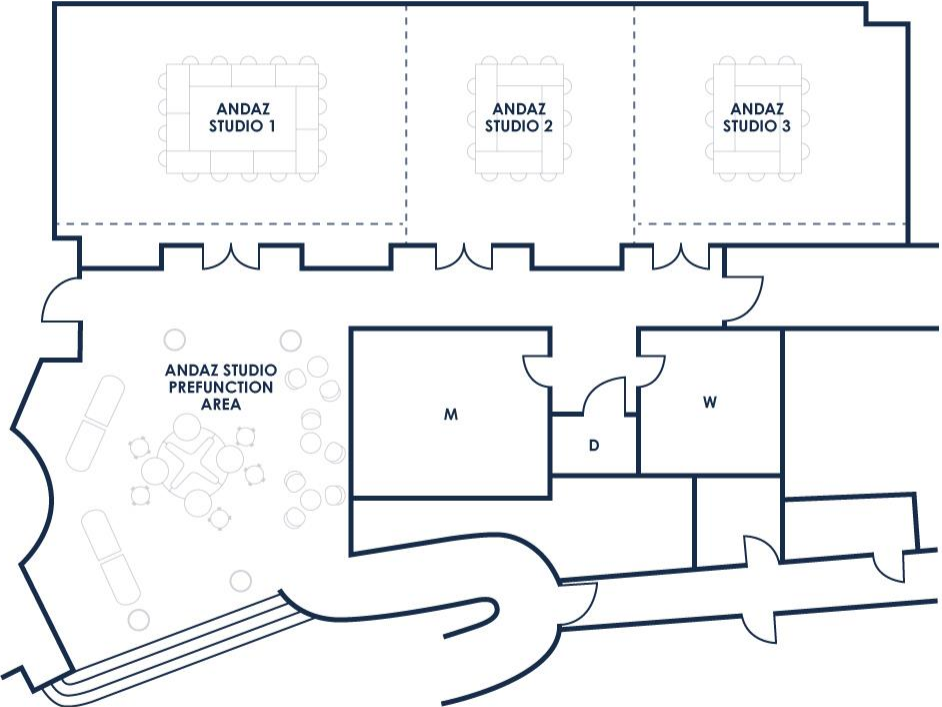

# FIRST FLOOR



TAKE THE TOUR

# UNIQUE EXPERIENCES:

## CREATIVE TEAMBUILDING WITH THE POWER OF MUSIC

### CRESCENDO – For groups of 8+ PAX

In less than one hour, your team will become a string orchestra! All your team members need are classical string instruments and our instructors. Results guaranteed and no previous musical training is needed. Experience the joy of creating music together!

[YouTube video](#)



### ORCHESTRATE – For groups of 20+ PAX

Let your team become a symphony orchestra in 2 hours! Groups of up to 80 people can tune-in and connect with each other in a truly memorable way. For the most exclusive experience, your concert can be organized in the famed Smetana Hall, within walking distance to Andaz Prague.

[YouTube video](#)

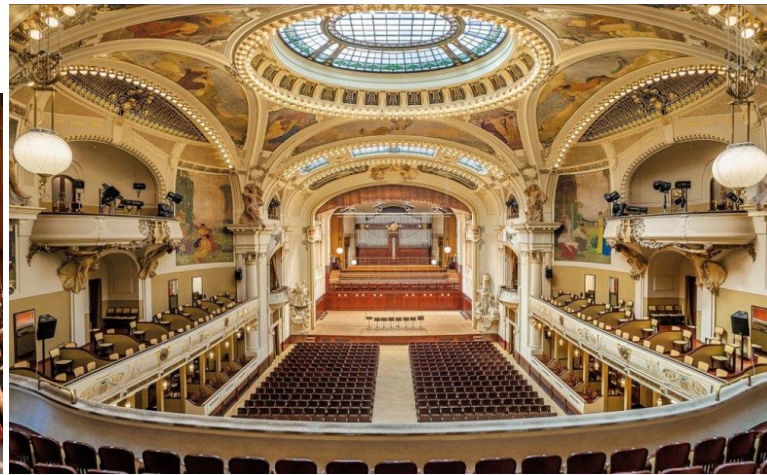



# UNIQUE EXPERIENCES:

## ONE-DAY TRIP TO THE “CRYSTAL VALLEY”

Czech crystal- and glasswork is known worldwide. You can find chandeliers of Czech origin in palaces of Sheikhs all over the Persian Gulf, as well as vases, statues, decorative glass and utility glass items in representative spaces of presidents and homes of celebrities.

This tour offers to you an opportunity to visit one of the most prominent glass production region of Czechia. You will not only watch art pieces in Pačinek glass garden and handwork of glassmakers in Lindava – Lasvit workshop, but you will also have the chance to try blowing your own glass piece, guided by an expert. After lunch in a traditional Czech restaurant, the guests will visit a modern design building of Lasvit headquarters richly decorated with a wide range of glass artifacts.

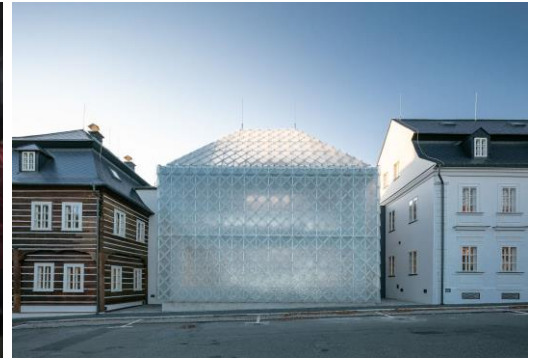

# UNIQUE EXPERIENCES:

## INTERACTIVE SCAVENGER HUNT INSPIRED BY THE MYTHS AND LEGENDS OF PRAGUE

Soak in the atmosphere of Prague's Old Town while completing tasks guided by a uniquely designed signature app, bringing Prague's myths and legends to life once again.

Learn about the famous Golem, Headless Templar, Begging Skeleton or Šemík and Horymýr as you explore the streets of the city.

- During this quest participants will get map full of various tasks (logical, creative) and interactive checkpoints (wooden brainteasers, cryptex and many more) as well as trained facilitators taking the players to the hidden gems of the city centre.

- Included:

Moderator and instructor

Staff for activity organisation per 30 participants

1 Tablet with GO TEAM app per team

Trails and checkpoints can be adjusted to match preferences

Interactive checkpoints free of charge for larger groups – 30 and more

(Historical person, Da Vinci bridge, Riddles and Mysteries, Survival, or other)

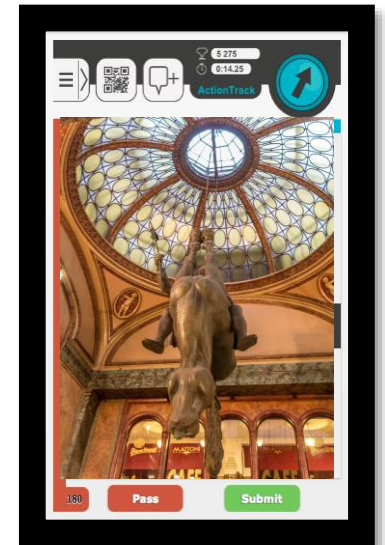

# UNIQUE EXPERIENCES:

PRIVATE GALA DINNER IN KLEMENTINUM

Welcome drink in the Astronomical Tower  
Visit of the baroque library  
Buffet or 3-course plated dinner

The Klementinum Complex, housing one of the world's most impressive classic libraries, is situated next to the Charles Bridge, right in the historical centre of Prague. Enjoy dinner in its gilded halls that's guaranteed to leave all those present in awe.





# UNIQUE EXPERIENCES:



## GRAFFITI WORKSHOP WITH A PROFESSIONAL GRAFFITI ARTIST: "SANY"

Unleash your imagination and create something cool together!

Spray away under the guidance of renowned graffiti artist [Sany](#) to create your own masterpiece under **3 hours**.

After a quick walk through one of Prague's legally allocated "free-to-spray" areas, you'll choose your own spot to leave your mark at.

During the workshop you'll learn the basics and brief history of this art form, and its part in the local culture and community.

At the end you'll be amazed what an incredible piece of art you managed to put together, even without any prior practice, thanks to [Sany](#) who is not only a talented artist, filmmaker, art manager but also a great instructor. 😊

As you can see, our team was definitely amazed:





# Mez

## BAR

- Upscale meeting place for locals and travellers
- Cocktails & specialty drinks inspired by Bohemian wisdom and mythology
- Spiced with South American vibe







# ZEM

## RESTAURANT



- Avant-garde Czech bistronomy
- Influences of authentic Izakaya, Japanese dishes
- Czech beers on tap Local & international wine selection
- Signature cocktails, sake, Shochu Japanese whiskies









THANK YOU